



Hilton
BRUSSELS GRAND PLACE

+32 (0)2 548 4211
sales.brusselsgrandplace@hilton.com



OUR ROOMS

GUEST ROOM

- Spacious and light guest rooms, king-size bed and welcome amenities.
- Large bathroom with high-end fixtures and a bathtub.
- All rooms benefit from soundproof windows, in-room safe, iron/ironing board and individually controlled air conditioning for your total comfort.
- Accessible rooms for guest with limited mobility.
- Big family room with king bed and sofa bed and unique family rooms with 2 queen beds.

EXECUTIVE ROOMS

- Premium amenities including JBL clock radio and Nespresso® tray.
- Bathroom with separate bathhub and shower.
- Exclusive access to the Executive Lounge serving continental breakfast, snacks and drinks.

JUNIOR AND ONE-BEDROOM SUITES AND PRESIDENTIAL SUITE

- Junior suites and One-bedroom suites featured with extra space.
- Premium amenities including JBL® clock radio and Nespresso® tray.
- Bathroom with separate bathhub and shower.
- Exclusive access to the Executive Lounge: serving continental breakfast, snacks and drinks.
- Presidential Suite with private dining room, and private elevator.

SENTRO LOUNGE & MORE

A centric location for the best gastronomic sensations, our restaurant offers a seasonal menu based on traditional Belgian and European recipes focused on sustainable and local sourcing of produce. An all Day Dining concept that incorporates healthy and light options taking into account dietary requirements.

Quoting our chef, Vincent Masson "this is a cuisine to share the culinary emotions of my different experiences in Europe". Emotions and sensations that awaken through different cooking methods like charcoal, plancha or the stone based oven, creating dishes with unique combinations of taste and texture which are served in warm terracota plating for a surprising culinary experience.

brusselsentro.com



MEETINGS AND EVENTS

We offer 15 renovated meeting spaces including two impressive light-filled ballrooms for up to 200 delegates. All feature state-of-the-art technology, wireless internet access and adaptable layouts. Our meeting rooms also allow for endless break out possibilities to maximise productivity and delegate engagement.

For an event with ultimate exclusivity, take the opportunity to privatise a whole floor, including the use of a separate entrance. As an extra convenience, make use of the underground public parking, with direct lift access to the meeting areas.

Our talented chefs will cater to your specific dietary needs, providing delicious and inventive menus, whilst our attentive Hilton Team Members will take care of every detail, ensuring that your event is a true success.

AT A GLANCE

- 224 guest rooms including suites.
- Complimentary Wi-Fi access.
- Prime location opposite the Central Station with direct access to Brussels International Airport in 15 minutes.
- 3-minutes walking distance to Square Brussels Meeting Centre.
- 3-minutes to Grand Place - UNESCO World Heritage Site.
- An exclusive, intimate Executive Lounge.
- Hilton Fitness 24 hours, 7 days a week.
- 15 meeting rooms including two impressive light-filled ballrooms for up to 200 delegates.
- Public underground parking with direct access to the hotel.



OUT AND ABOUT

With its prime location right at the heart of the historic city centre, ideally set between the beautiful Grand Place and the Square Meeting and Convention Centre, Hilton Brussels Grand Place is the perfect choice for business or leisure.

LOCATION

DIRECT ACCESS TO AIRPORT: Taxis are available outside the Arrivals Terminal for a quick 20-minute drive to the hotel. Direct, regularly scheduled trains are also available, and reach Central Station in only 20 minutes.

FROM THE TRAIN STATION: from Brussels-South (Thalys, Eurostar & SNCB) 5 minutes by train.



Picture: Executive room

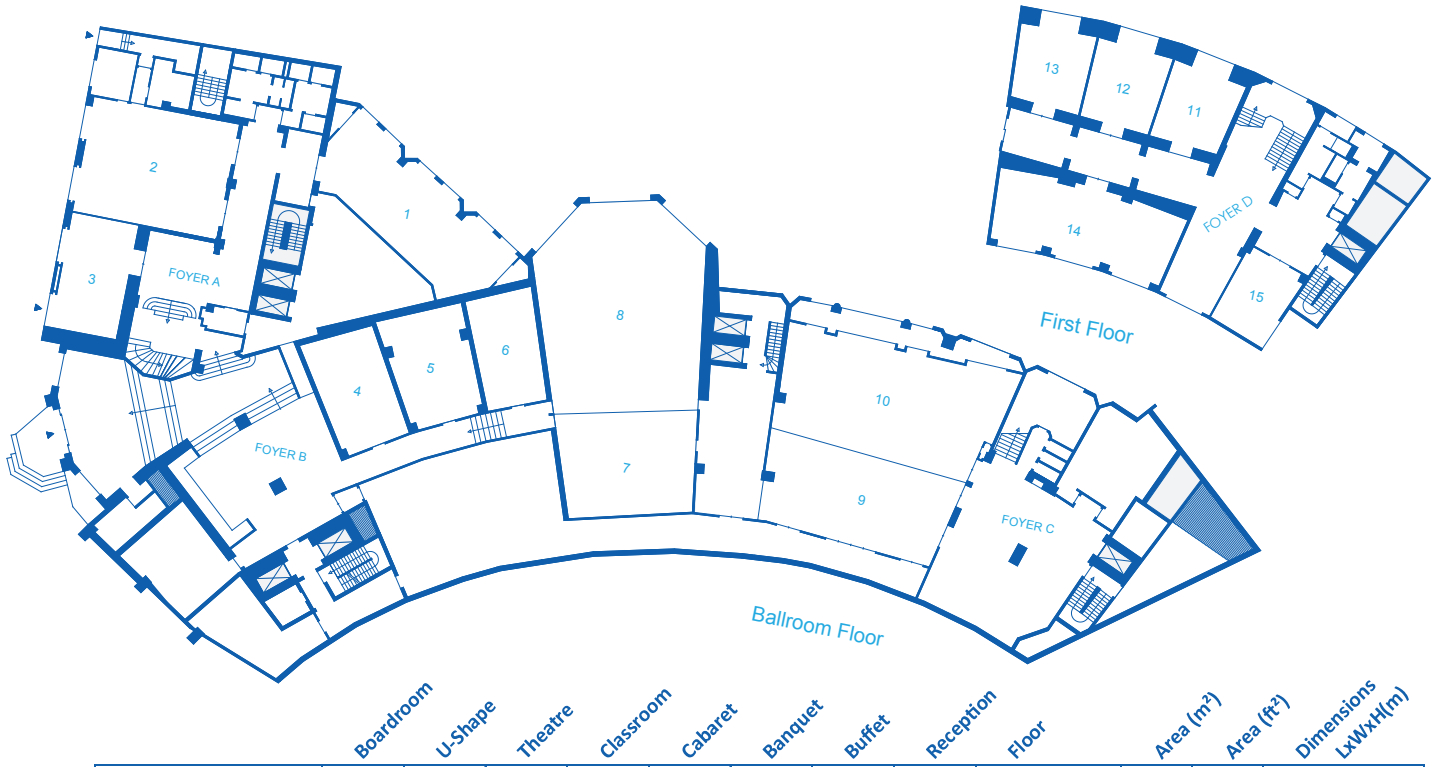

	Boardroom	U-Shape	Theatre	Classroom	Cabaret	Banquet	Buffet	Reception	Floor	Area (m ²)	Area (ft ²)	Dimensions LxWxH(m)
Meeting room 1	24	15	50	18	24	40	40	60	Ballroom Floor	76	807	10,7 x 5,3 x 3,1
Meeting room 2	21	20	70	40	35	50	50	60	Ballroom Floor	79	850	9,9 x 7,8 x 3,1
Meeting room 3	10	-	20	-	6	-	-	15	Ballroom Floor	38	409	7,8 x 4,9 x 3,1
Foyer A	-	-	-	-	-	-	45	45	Ballroom Floor	35	366	7,5 x 4,4 x 3,1
Foyer B	-	-	-	-	-	-	80	100	Ballroom Floor	161	1733	-
Meeting room 4	12	-	-	-	-	-	-	-	Ballroom Floor	38	409	8 x 5 x 3,2
Meeting room 5	12	-	-	-	-	-	-	-	Ballroom Floor	40	430	7,2 x 4,2 x 3,2
Meeting room 6	12	-	-	-	-	-	-	-	Ballroom Floor	32	344	7,5 x 4 x 3,2
Meeting room 7	-	-	-	-	-	-	-	-	Ballroom Floor	62	667	8,3 x 6,8 x 3,8
Meeting room 8	22	30	120	84	60	66	60	120	Ballroom Floor	142	1528	14 x 9,6 x 3,8
Ballroom 7+8	46	42	200	120	100	120	120	200	Ballroom Floor	204	2196	21 x 8,3 x 3,8
Ballroom 9+10	38	42	180	100	80	100	110	160	Ballroom Floor	184	1980	14,2 x 11,8 x 3,8
Foyer C	-	-	-	-	-	-	80	80	Ballroom Floor	90	969	10,1 x 7,1 x 3,1
Meeting room 11	9	-	9	9	-	-	-	-	First Floor	29	312	4,9 x 5 x 2,6
Meeting room 12	9	-	9	9	-	-	-	-	First Floor	30	323	5,4 x 4,7 x 2,6
Meeting room 13	9	-	9	9	-	-	-	-	First Floor	30	323	6,7 x 4,7 x 2,6
Meeting room 11+12+13	27	24	70	40	45	60	60	90	First Floor	91	979	14,3 x 4,9 x 2,6
Meeting room 14	22	22	50	24	30	48	40	60	First Floor	63	678	11,7 x 4,8 x 2,7
Foyer D	-	-	-	-	-	-	70	70	First Floor	45	484	11 x 3,7 x 2,6
Meeting room 15	10	-	-	-	-	-	-	-	First Floor	23	247	3,7 x 5,1 x 2,7
Sentro Lounge & More*	-	-	-	-	-	45	45	-	Ground Floor	370	3983	-
Veranda	20	-	-	-	-	20	20	40	Ground Floor	56	603	7,7 x 3,4 x 3,1
Alba Breakfast & Dining*	-	-	-	-	-	110	110	-	Ground Floor	214	2303	20,1 x 12,6 x 3,2
Cedra	-	-	-	-	5	-	-	5	Ground Floor	14	151	3,9 x 3,6 x 3,2



HILTON BRUSSELS GRAND PLACE

BrusselsGrandPlace.hilton.com

Carrefour de l'Europe 3

1000 Brussels

+32 (0)2 548 4211 | +32 (0)2 548 4735

sales.brusselsgrandplace@hilton.com

